

14
million pound
refurbishment.

400
delegates
accommodated
in one suite.

12
miles from
central Glasgow.

7
outstanding
conference rooms.

You. Us. Your event.
One of a kind.

QHOTELS

The Westerwood

HOTEL & GOLF RESORT

Nr Glasgow

One of 21 outstanding QHotels.



Hotel Group of the Year
2008 - 2009



20
minutes from
Glasgow.

50
minutes from
Edinburgh.

The Westerwood Hotel & Golf Resort isn't just a wonderful location, it is also wonderfully located. That's because this superb, recently refurbished establishment with its to-die-for views to the Campsie Hills, its Championship Golf Course designed by Seve Ballesteros, its 148 delightful rooms and its seven highly versatile conference rooms with a capacity of up to 400, just happens to be situated within easy striking distance of Glasgow, Edinburgh and Stirling. Indeed, we reckon our hotel is handy for just about anybody to get to, being, as it is, no more than 30 miles from two major airports and five miles from the nearest railway station. Add to all this essential convenience the incredible professionalism and dedication of our team, and it isn't hard to understand why The Westerwood Hotel & Golf Resort really is one of a kind.





- Just 20 minutes from Glasgow.
- 50 minutes from Edinburgh.
- 400 acres of beautiful countryside.
- 148 fantastic bedrooms.
- 18-hole Championship Golf Course.
- Space for 400 delegates in state-of-the-art conference facilities.
- 250 complimentary car parking spaces.
- Leisure and spa facilities on site.
- 25 miles from Glasgow International Airport.
- £14 million refurbishment.
- Free WiFi for all delegates for the duration of their stay.



400

delighted delegates.



We love our business guests to feel they are spoilt for choice when they come to The Westerwood Hotel & Golf Resort. That's why in 2007 we decided to add, just for good measure, the superb Carrick Suite to our already impressive menu of conference rooms. This exceptional space offers a 400-delegate capacity, a highly flexible layout, ground-floor location and even its very own foyer. Which, as you might imagine, makes it the envy of almost every other venue north of the border. On top of that we can provide you with cosy meeting rooms and airy function rooms (including the Club Room with its own private bar). Not forgetting, of course, the full support of our highly experienced and bend-over-backwards enthusiastic team who will be with you every step of the way to help you plan and implement an event that will meet all your objectives.



Ground Floor



Room	Size m ²	Length m	Width m	Height m	Cabaret	Theatre	Boardroom	U-Shape	Classroom	Banquet	Reception	Dinner Dance
Carrick Suite	389.24	26.4	15	4.5	180	400	n/a	n/a	n/a	360	300	300
Carrick 1	125.8	8.5	15	4.5	60	120	36	40	50	100	n/a	n/a
Carrick 2	130.24	8.5	15	4.5	60	120	36	40	50	100	n/a	n/a
Carrick 3	131.72	8.5	15	4.5	60	120	36	40	50	100	100	

First Floor

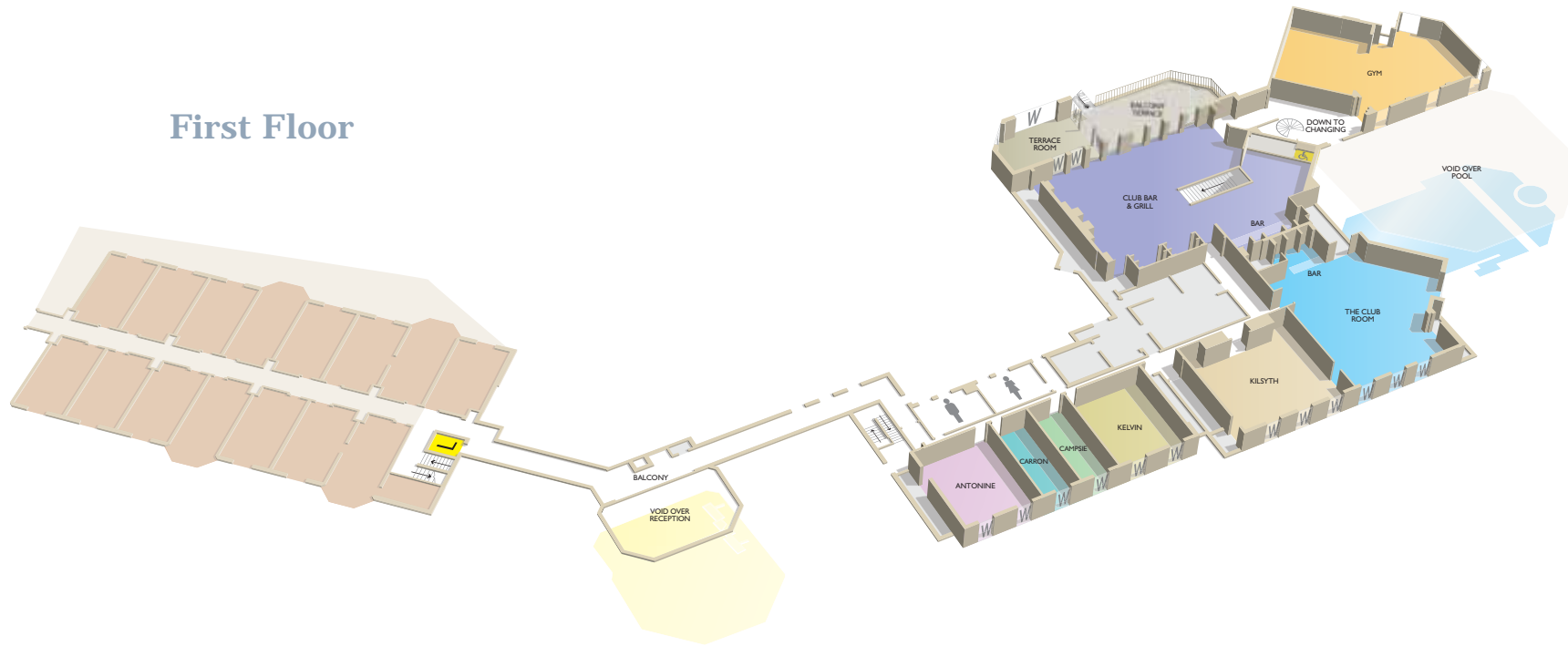

Room	Size m ²	Length m	Width m	Height m	Cabaret	Theatre	Boardroom	U-Shape	Classroom	Banquet	Reception	Dinner Dance
Club Room	178.59	13.55	13.18	2.7	48	100	30	30	30	90	n/a	80
Kilsyth Room	87.42	9.66	9.05	2.7	24	60	20	18	20	40	n/a	n/a
Kelvin Room	48.58	7.65	6.35	2.7	18	40	16	15	18	24	n/a	n/a
Antonine Room	47.81	7.65	6.35	2.7	18	40	16	15	18	24	n/a	n/a
Carron Room	23.33	7.65	3	2.7	n/a	20	10	n/a	n/a	n/a	n/a	n/a
Campsie Room	23.33	7.65	3	2.7	n/a	20	10	n/a	n/a	n/a	n/a	n/a

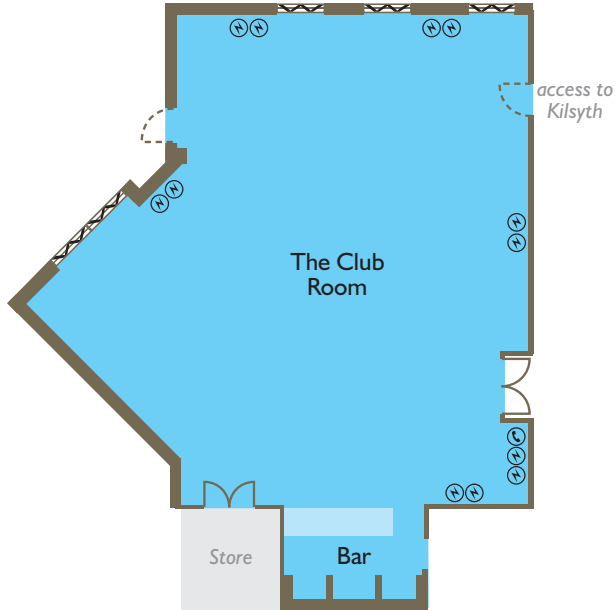

CLUB ROOM (First Floor)

CAPACITIES

Maximum Capacity	100
Classroom	30
Boardroom	30
U-shape	30
Banquet	90
Dinner Dance	80
Theatre	100
Cabaret	48

DIMENSIONS (m)

Room Size	178.59m ²
Length	13.55
Width	13.18
Height	2.7

FEATURES

Air Conditioning
Natural Daylight
Breakout Area
Bar



KELVIN ROOM (First Floor)

CAPACITIES

Maximum Capacity	40
Classroom	18
Boardroom	16
U-shape	15
Banquet	24
Dinner Dance	n/a
Theatre	40
Cabaret	18

DIMENSIONS (m)

Room Size	48.58m ²
Length	7.65
Width	6.35
Height	2.7

FEATURES

Air Conditioning
Natural Daylight

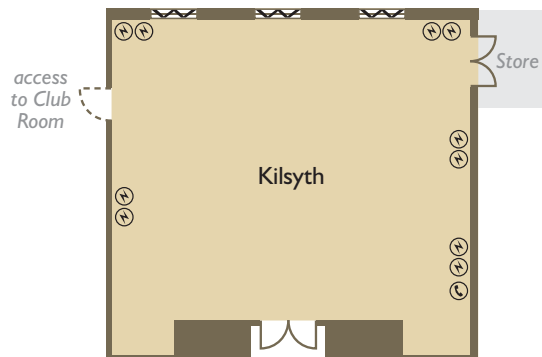

KILSYTH ROOM (First Floor)

CAPACITIES

Maximum Capacity	60
Classroom	20
Boardroom	20
U-shape	18
Banquet	40
Dinner Dance	n/a
Theatre	60
Cabaret	24



DIMENSIONS (m)

Room Size	87.42m ²
Length	9.66
Width	9.05
Height	2.7

FEATURES

Air Conditioning
Natural Daylight

KEY

-  TELEPHONE POINT
-  POWER SUPPLY
-  AERIAL POINT



CAMPSIE ROOM (First Floor)

CAPACITIES	
Maximum Capacity	20
Classroom	n/a
Boardroom	10
U-shape	n/a
Banquet	n/a
Dinner Dance	n/a
Theatre	20
Cabaret	n/a

DIMENSIONS (m)	
Room Size	23.33m ²
Length	7.65
Width	3
Height	2.7

FEATURES
Air Conditioning
Natural Daylight

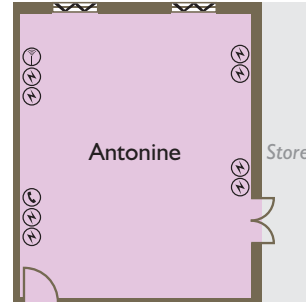

ANTONINE ROOM (First Floor)

CAPACITIES	
Maximum Capacity	40
Classroom	18
Boardroom	16
U-shape	15
Banquet	24
Dinner Dance	n/a
Theatre	40
Cabaret	18

DIMENSIONS (m)	
Room Size	47.81m ²
Length	7.65
Width	6.35
Height	2.7

FEATURES
Air Conditioning
Natural Daylight



CARRON ROOM (First Floor)

CAPACITIES	
Maximum Capacity	20
Classroom	n/a
Boardroom	10
U-shape	n/a
Banquet	n/a
Dinner Dance	n/a
Theatre	20
Cabaret	n/a

DIMENSIONS (m)	
Room Size	23.33m ²
Length	7.65
Width	3
Height	2.7

FEATURES
Air Conditioning
Natural Daylight

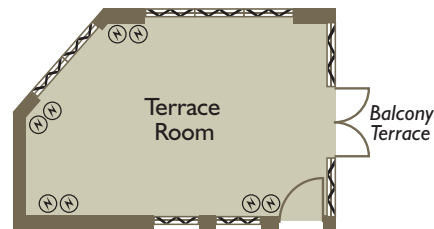

TERRACE ROOM (First Floor)

CAPACITIES	
Maximum Capacity	25
Classroom	n/a
Boardroom	15
U-shape	n/a
Banquet	n/a
Dinner Dance	n/a
Theatre	25
Cabaret	n/a

DIMENSIONS (m)	
Room Size	39m ²
Length	8.2
Width	4.8
Height	3

FEATURES
Air Conditioning
Natural Daylight

400

delegates accommodated
in one room.

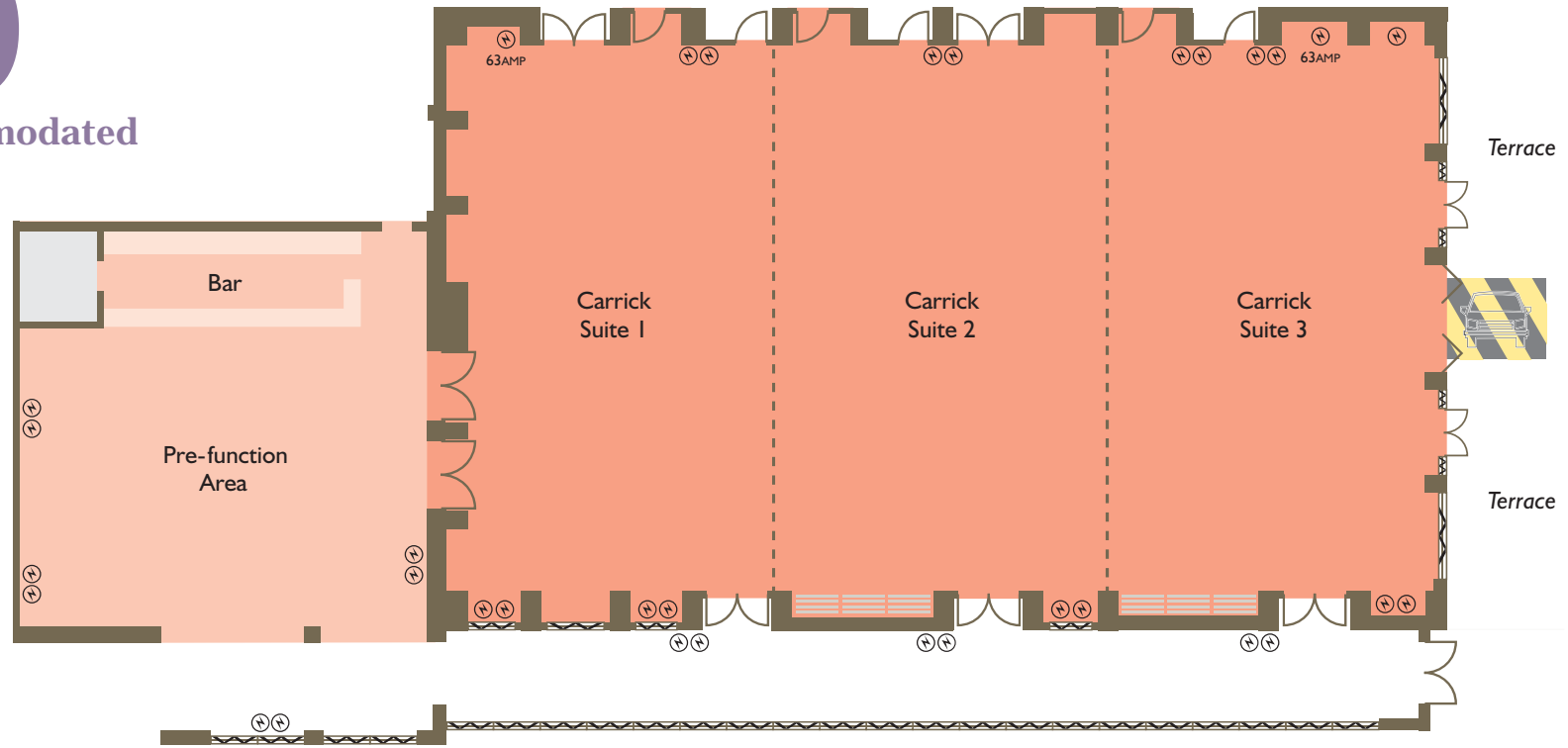

CARRICK SUITE (Ground Floor)

OVERALL 3 SUITES

CAPACITIES

Maximum Capacity	400
Classroom	n/a
Boardroom	n/a
U-shape	n/a
Banquet	360
Dinner Dance	300
Theatre	400
Cabaret	180

DIMENSIONS (m)

Room Size	389.24m ²
Length	26.4
Width	15
Height	4.5

FEATURES

Air Conditioning
Natural Daylight
Breakout Area
Bar

CARRICK 1

CAPACITIES

Maximum Capacity	120
Classroom	50
Boardroom	36
U-shape	40
Banquet	100
Dinner Dance	n/a
Theatre	120
Cabaret	60

DIMENSIONS (m)

Room Size	125.8m ²
Length	8.5
Width	15
Height	4.5

FEATURES

Air Conditioning
Natural Daylight

CARRICK 2

CAPACITIES

Maximum Capacity	120
Classroom	50
Boardroom	36
U-shape	40
Banquet	100
Dinner Dance	n/a
Theatre	120
Cabaret	60

DIMENSIONS (m)

Room Size	130.24m ²
Length	8.5
Width	15
Height	4.5

FEATURES

Air Conditioning
Natural Daylight

CARRICK 3

CAPACITIES

Maximum Capacity	120
Classroom	50
Boardroom	36
U-shape	40
Banquet	100
Dinner Dance	n/a
Theatre	120
Cabaret	60

DIMENSIONS (m)

Room Size	131.72m ²
Length	8.5
Width	15
Height	4.5

FEATURES

Air Conditioning
Natural Daylight

Terrace

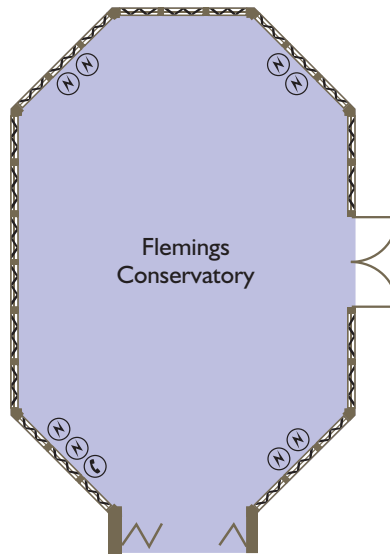

FLEMINGS CONSERVATORY (Ground Floor)

CAPACITIES

Maximum Capacity	70
Classroom	20
Boardroom	20
U-shape	20
Banquet	n/a
Dinner Dance	70
Theatre	70
Cabaret	36

DIMENSIONS (m)



Room Size	77m ²
Length	11.2
Width	6.9
Height	3

FEATURES

Air Conditioning
Natural Daylight



KEY

-  TELEPHONE POINT
-  POWER SUPPLY
-  AERIAL POINT



5

therapists to calm your karma.

You don't need us to tell you just how much a full-on day doing business can take it out of a person. Honestly, it can be positively exhausting! Fear not, however, the contents of our lavish leisure club will soon have the batteries fully restored. Here, you will find no less than five beauty therapists whose sole mission in life it is to ease away the aches and pains of the day, while our fully equipped, hi-tech gym boasts everything you could possibly need to work up a healthy appetite for dinner. Beyond this oasis of bodily goodness lies our magnificent 18-hole Championship Golf Course, set amid stunning scenery and designed to put even the most self-assured of golfers to the test. Further afield you will find distractions aplenty – the best nightlife Scotland has to offer in Glasgow, the culture of Edinburgh City Centre and of course, if you need some retail therapy, you can browse the shops of Scotland's foremost city centres.

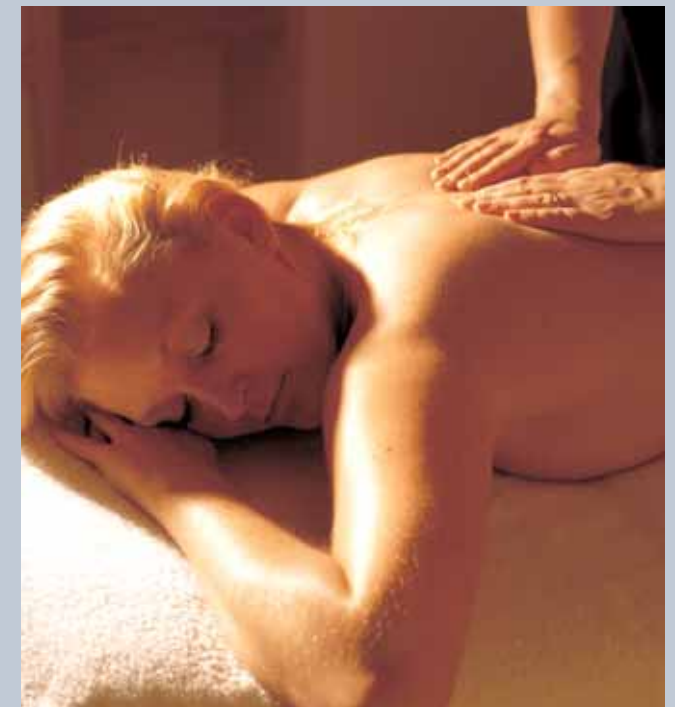



263

delicious dining options.



Whether you help yourself from the breakout area or we bring your refreshments to you, our sugar-boosting, energy-building snacks, coupled with endless amounts of freshly brewed coffee and tea, make sure that you're fully refreshed all day long. But if you'd rather not hit the caffeine all day, we can also make sure a wide selection of green and fruit teas are always available to help you keep your thirst at bay. As for meals, sometimes it's good to leave the meeting room. So if you've got time, why not head to Flemings Restaurant or the Club Bar and Grill and sample traditional Scottish hospitality while enjoying the view of our Championship Golf Course. Don't worry if you're pushed for time, we can always bring you a business buffet and you can work through lunch while working through some delicious dishes. But whatever kind of lunch or evening meal experience you want, you'll find we'll have flexible, tailor-made solutions that cater for you. We can arrange a private room if you want to really make sure the team gets to know each other, or we can give you a separate area of the restaurant. Whatever your tastes, we'll endeavour to give you exactly what you need.

400

acres of grounds for bounding,
bonding and building.

Here at The Westerwood Hotel & Golf Resort we've got spectacular grounds stretching off into the distance in every direction. And we aren't afraid to use them. In fact, all 400 wonderful acres are at your disposal for team-building days that will soon have everyone pulling together as one finely honed unit. We will happily accommodate any ideas of your own that you may wish to try out, or you can choose from the smorgasbord of challenges offered by our highly recommended team-building partner. These range from the slightly less daunting themes of giant-inflatable obstacle courses, crazy golf and duck herding, to the somewhat more surreal activities of mini-highland games, It's A Knockout and giant jenga. You can even opt to go off-site to try archery, clay pigeon shooting and off-road driving.



4

ways of getting total peace of mind.

Our Total Meetings Package offers four different ways of tailoring our offering to your needs, and depending on the package can include everything from rooms, facilities and support, to meals and accommodation. It's an excellent way of ensuring that you get precisely what you need and at an all-inclusive price with no hidden extras. It even includes free 24-hour Wi-Fi access for all your delegates. How totally cool is that.

Directions

From the south and Glasgow, join the M74 and take the M73 following signs for Stirling. Join the A80 following signs to Stirling. Take the first slip road signposted Dullatur then at the roundabout take the first exit. At the next smaller roundabout, take the right hand turn into St Andrews Drive.

From Edinburgh, following signs for the M9. Join the motorway and follow signs for Glasgow until you reach the Glasgow/Carlisle exit on the A876. The road joins the A80 towards Glasgow. Take the second slip road to Dullatur. At the roundabout take the second left and at the second roundabout take the right hand exit into St Andrews Drive.

BY RAIL

Croy Station – 5 miles.
Glasgow Queen Street Station – 20 miles.

BY AIR

Glasgow International Airport – 25 miles.
Edinburgh International Airport – 30 miles.

For reservations and general enquiries
please call 01236 457171

Email: westerwoodevents@QHotels.co.uk
or visit www.QHotels.co.uk

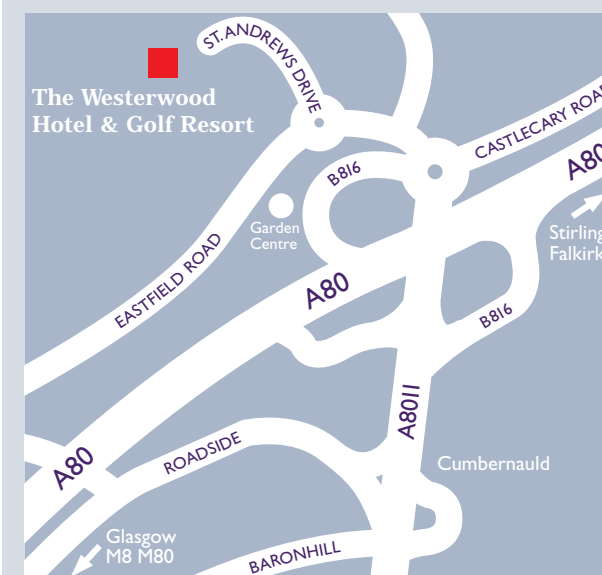

The gorgeousness doesn't end here. There are 20 other QHotels to visit across the country.

**Aldwark Manor
Golf & Spa Hotel**
York

The Queens
Leeds

Tankersley Manor
Tankersley, Nr Sheffield

The Midland
Manchester

The Park Royal
Stretton, Cheshire

Crewe Hall
Crewe, Cheshire

**Forest Pines
Hotel & Golf Resort**
North Lincolnshire

The Nottingham Belfry
Nottingham

Telford Hotel & Golf Resort
Shropshire

Stratford Manor
Stratford-upon-Avon

The Stratford
Stratford-upon-Avon

Chesford Grange
Kenilworth, Warwickshire

**Hellidon Lakes
Golf & Spa Hotel**
Hellidon, Northamptonshire

The Cambridge Belfry
Cambourne, Cambridge

The Cheltenham Chase Hotel
Gloucestershire

The Oxford Belfry
Thame, Oxford

The Hampshire Court Hotel
Basingstoke, Hampshire

Norton Park
Winchester, Hampshire

Bridgewood Manor
Chatham, Kent

Ashford International Hotel
Ashford, Kent

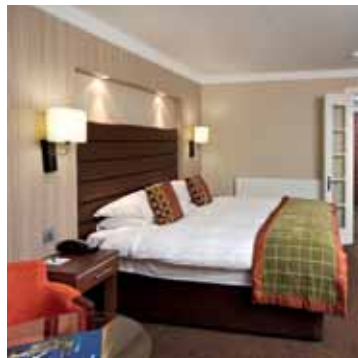

The Westerwood Hotel & Golf Resort
St Andrew's Drive
Nr Glasgow
Scotland G68 0EW

Tel: 01236 457 171
Fax: 01236 738 478
Email: westerwoodevents@QHotels.co.uk
www.QHotels.co.uk

Galileo – QH51510
Sabre – QH64468

Amadeus – QHGLA002
Worldspan – QHWESTE

QHOTELS

You can take advantage of all we have to offer secure in the knowledge that everything we do at QHotels ensures a positive approach to our staff, our community and the environment.



Hotel Group of the Year
2008 - 2009